

Connector	Adapter
20mm Bosch profile	 SG.C.PR.20

Mounting of End of Arm Tooling – Connector

The adapter is installed to the profile using the bolting provided. The EoAT-Connector is locked by a M4 screw and a slot nut in the profile. The joint to the Finger is a bayonet lock as it is to all SoftGripper platforms.

To replace a Finger, turn it clockwise until you can take it out of the socket. A new one is then put in and turned counterclockwise until a click of the lock is reached.



Every EoAT-Connector is provided with its own port for pneumatics and can therefore be operated separately or in groups by using pneumatic fittings or distributors.

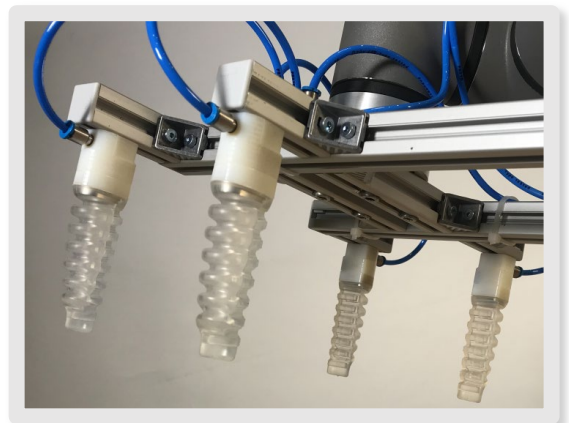

Available SoftGripper Finger and Angle Adapters



Finger Shore A60
SG.F60S



60° Adapter
(optional)
SG.WA.60D

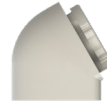

90° Adapter
(optional)
SG.WA.90D

Characteristics of Finger and EoAT Adapters

Finger Material	Silicone
Operating Pressure	- 0.5 to 1.0 bar
Grip Force per Finger	3,5 N
Durability	> 1 Mio. Cycles @1.0 bar, 0.5 Hz
Air Pressure Connection	M3

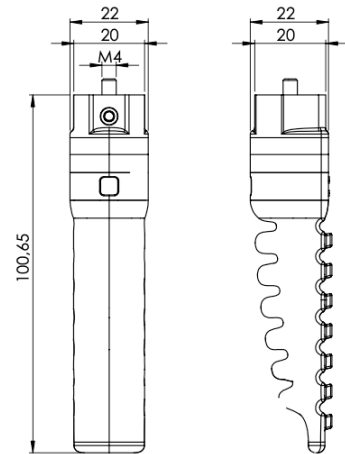

Use cases

